

Although every attempt has been made to ensure accuracy, all measurements are approximate.
The floorplan is for illustrative purposes only and not to scale.
© www.perspective.co.uk

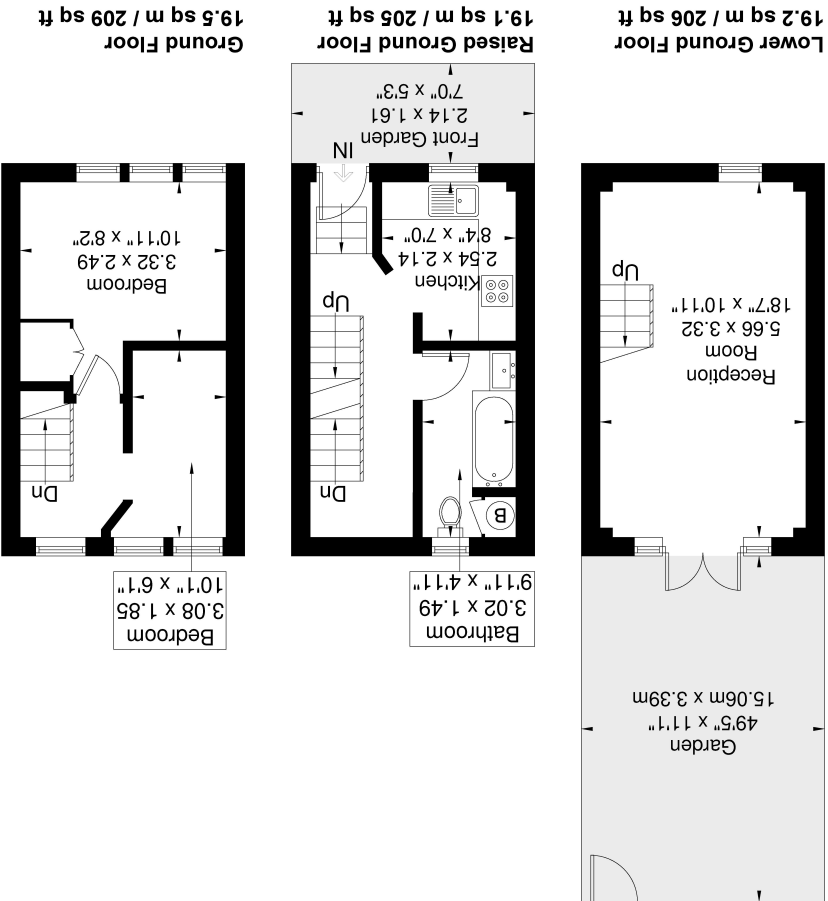

Springfield Road
Approximate Gross Internal Area = 57.8 sq m / 620 sq ft



8B Springfield Road, Hanwell, LONDON. W7 3JP.

£625,000



Charming and characterful two-bedroom terraced home, quietly situated on the highly sought-after Springfield Road, Hanwell. Set within an attractive converted Victorian warehouse, this handsome property combines period charm with a bright and contemporary interior.

Arranged over three floors, the home features a modern kitchen and smart bathroom on the raised ground floor, a light and spacious reception room on the lower level with French doors opening onto a beautiful south-west facing landscaped garden, and two bedrooms on the upper floor. The layout offers a perfect balance of style and practicality, enhanced by neutral décor, fitted carpets, wood-effect floors, and sash-style windows that retain its Victorian character.

Externally, the landscaped rear garden is a true highlight — private, well-maintained, and ideal for relaxing or entertaining. The property is chain free and move-in ready, while still offering excellent potential to extend further into the loft or to the rear (STPP).

Located moments from the green open spaces of Connolly Dell and the ‘Bunny’ Park, and within easy reach of Hanwell Station (Elizabeth Line) offering swift access to Ealing Broadway, Paddington, Bond Street and Heathrow). Springfield Road also benefits from a friendly community feel, excellent local schools, and a range of independent cafés, pubs and shops along Uxbridge Road and Greenford Avenue.

Kitchen

8' 4" x 7' 0" (2.54m x 2.13m)

Bathroom

9' 11" x 4' 11" (3.02m x 1.50m)

Reception

18' 7" x 10' 11" (5.66m x 3.33m)

Garden

Bedroom

10' 11" x 8' 2" (3.33m x 2.49m)

Bedroom

10' 1" x 6' 1" (3.07m x 1.85m)

