

Although every attempt has been made to ensure accuracy, all measurements are approximate.  
The floorplan is for illustrative purposes only and not to scale.  
© www.perspective.co.uk

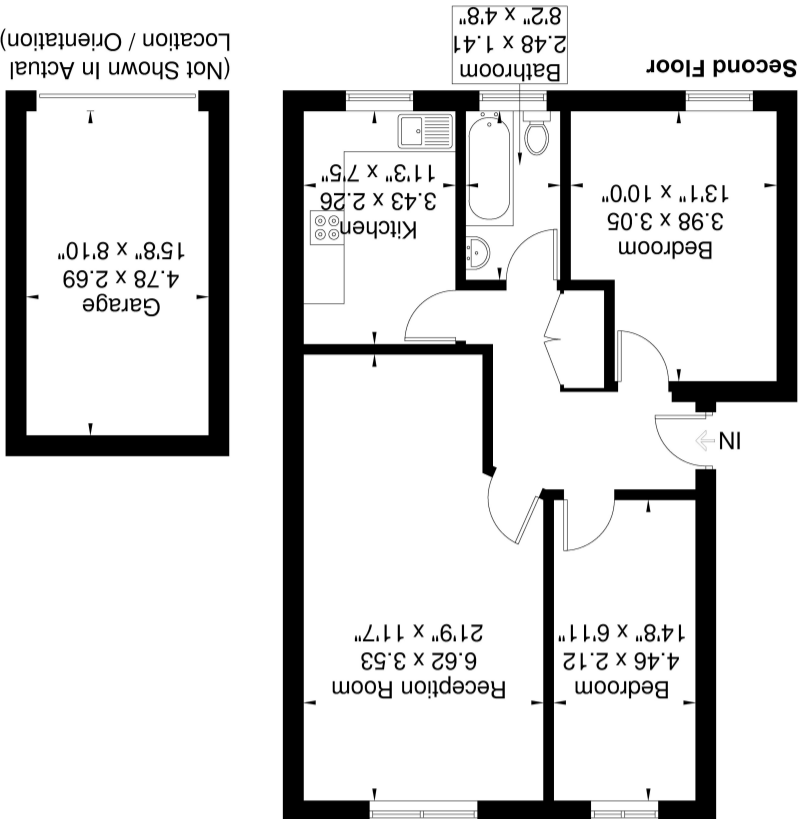

Silverdale Court  
Approximate Gross Internal Area = 63.9 sq m / 687 sq ft  
Garage = 12.9 sq m / 138 sq ft  
Total = 76.8 sq m / 825 sq ft



19 Silverdale Close, Hanwell, London. W7 3HR.

£350,000



Tucked away in a quiet residential cul-de-sac in the heart of Hanwell, this well-proportioned two-bedroom second-floor apartment offers over 680 sq ft of internal space, plus a private garage and residents' parking – a superb opportunity for first-time buyers, downsizers, or buy-to-let investors. Set within the well-kept Silverdale Close development, the flat features a 21'9" dual-aspect reception room, two generous bedrooms, a separate fitted kitchen, and a full bathroom. Large windows throughout bring in excellent natural light, and the property is offered in clean, neutral decorative order. The apartment is offered chain-free and benefits from a long lease and low outgoings, making it a straightforward and attractive purchase.

Located just off Cherington Road in Hanwell, Silverdale Close is a quiet and leafy cul-de-sac offering peace and privacy, yet excellent connectivity. You're within easy reach of Hanwell Station (Elizabeth Line) for fast links into Paddington, the West End, City and Heathrow. The A40 and M4 are also nearby for those commuting by car. The property is ideally placed for access to local shops, cafés and amenities, with Elthorne Park, Brent Lodge Park, and the Grand Union Canal all close by — providing plenty of green space and walking routes. With its excellent location, garage and generous room sizes, this apartment represents great value in a growing West London neighbourhood

Reception

21' 9" x 11' 7" (6.63m x 3.53m)

Kitchen

11' 3" x 7' 5" (3.43m x 2.26m)

Bedroom 1

13' 1" x 10' 0" (3.99m x 3.05m)

Bedroom 2

14' 8" x 6' 11" (4.47m x 2.11m)

Bathroom

8' 2" x 4' 8" (2.49m x 1.42m)

