



# castle

**Flat 102, Crane Court, Gurnell Grove  
West Ealing, London, W13 0AQ  
£265,000**



Calling all Cash Buyers ! Offered to the market with no onward chain, this three bedroom split level flat is presented to the market in good condition. The property is located opposite the Gurnell Grove Leisure Centre with also multiple bus routes into Ealing Broadway and Greenford close by as well as day to day shops.

The property briefly comprises of three bedrooms, bathroom with separate WC, reception and a kitchen / dining room.

**Kitchen / Diner**

15' 2" x 14' (4.62m x 4.27m) Front aspect double glazed window, range of eye and base level units with integral stainless steel one and half bowl sink, electric hob with oven under and extractor hood over, plumbing and space for washing machine, tiled floor, spot lights

**Reception**

15' 2" x 13' 1" (4.62m x 3.99m) Rear aspect double glazed window, laminate floor, spots lights, radiator

**Bedroom 1**

11' 5" x 8' 9" (3.48m x 2.67m) Front aspect double glazed window, laminate floor, radiator

**Bedroom 2**

15' 2" x 8' 10" (4.62m x 2.69m) Rear aspect

double glazed window, radiator, laminate floor

**Bedroom 3**

11' 2" x 6' 1" (3.40m x 1.85m) Rear aspect double glazed window, radiator, laminate floor

**Bathroom**

Front aspect double glazed frosted window, panel enclosed bath, pedestal wash hand basin, tiled walls, radiator, separate WC downstairs

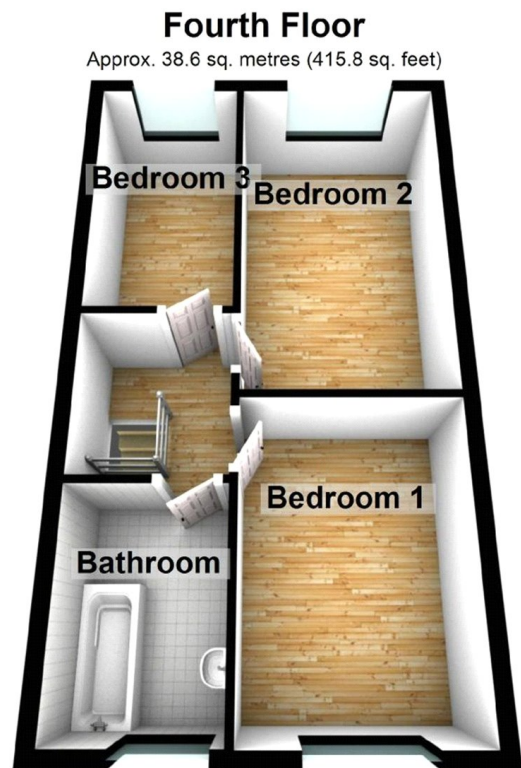
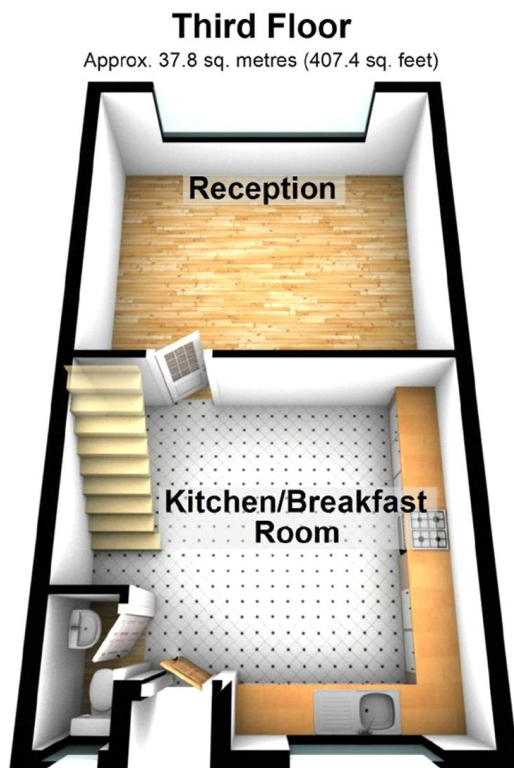

Total area: approx. 76.5 sq. metres (823.2 sq. feet)