

Total area: approx. 66.2 sq. metres (712.9 sq. feet)

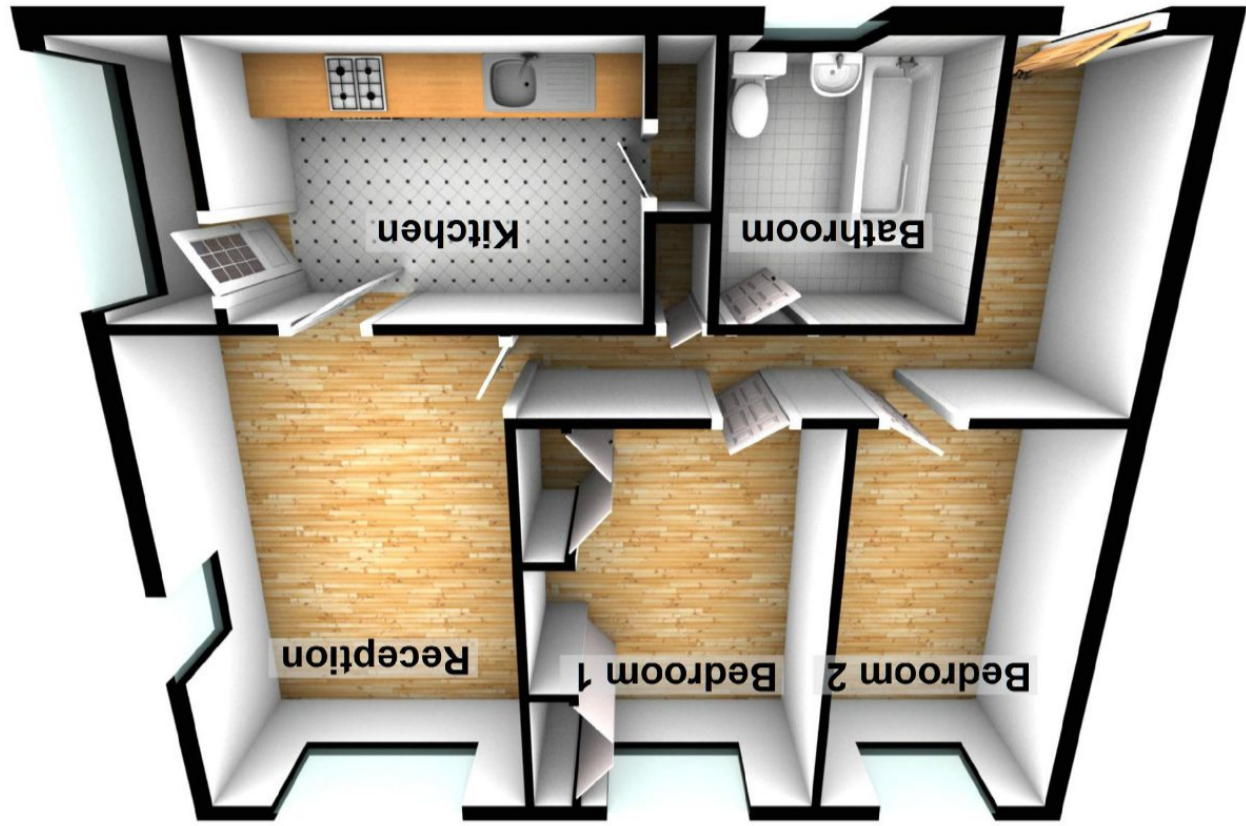

Second Floor
 Approx. 66.2 sq. metres (712.9 sq. feet)



Flat 289, Dunlin House Gurnell Grove, West Ealing,
 London. W13 0AG. £249,000

Cash Buyers required for this two bedroom second floor flat, presented to the market in good condition. The property is located opposite the Gurnell Grove Leisure Centre with also multiple bus routes into Ealing Broadway and Greenford close by as well as day to day shops.

The property briefly comprises of two bedrooms, bathroom with separate WC, reception and a good sized kitchen. Offered to the market with no onward chain.

Reception

16' 10" x 10' 11" (5.13m x 3.33m) Dual aspect double glazed windows, laminate floor, radiator door to

Kitchen

11' 7" x 7' 1" (3.53m x 2.16m) Side aspect double glazed window, range of eye and base level units, stainless steel single drainer sink, gas cooker point, larder cupboard, plumbing for washing machine

Bedroom 1

14' x 9' 9" (4.27m x 2.97m) Rear aspect double glazed window, laminate floor, radiator, fitted wardrobes

Bedroom 2

14' x 8' 2" (4.27m x 2.49m) Rear aspect double glazed window, laminate floor, radiator

Bathroom

Front aspect double glazed frosted, panel enclosed bath with shower, low level wc, pedestal wash hand basin

